

# Model PT4000

## UNIVERSAL S-BEAM LOAD CELL



The PT4000 S-Type tension load cell is available in both metric and imperial capacities.

It has the largest capacity range of any of our load cells: 50lb to 45klb (UNF thread) in imperial and 20kg to 5t (Metric thread) in metric.

Most capacities feature a \*3mV/V output built into a rugged alloy tool steel design with low sensitivity to axial loads.

Ideal for mechanical scale conversions, material testing, bi-directional, level and inventory monitoring and a host of other applications.

Sealed to IP67 and accepting standard US/EEC fittings, the PT4000 comes with a full range of mounting accessories.

## APPLICATIONS

- Tension/compression weighing
- Hanging tank, bin hopper, crane weighing
- Materials testing, bi-directional

## FEATURES

- \*3mV/V output (45klb 2mV/V)
- Wide capacity range 20kg ~ 5t & 50lb ~ 45klb
- Rugged alloy tool steel electroless nickel plated
- US and metric threads

## Specifications

Note: All specifications are a maximum, as a % ( $\pm$ ) of full load, unless otherwise stated.

Nominal Capacity	50lb ~ 45klb	Safe Load	150% of Rated Capacity
	20kg ~ 5t	Safe Sideload	100% of Rated Capacity
Signal Output at Capacity	*3mV/V $\pm$ 0.1% *45klb2mV/V	Ultimate Load	300% of Rated Capacity
Linearity Error	< 0.017% FSO	Input Resistance	415 $\Omega$ $\pm$ 15 $\Omega$
Non-Repeatability	< 0.010% FSO	Output Resistance	352 $\Omega$ $\pm$ 3 $\Omega$
Combined Error	< 0.023% FSO	Insulation Resistance	> 5000 M $\Omega$ at 100V DC
Hysteresis	< 0.020% FSO	Excitation Voltage (Recommended)	5 ~ 15V AC/DC
Creep/Zero Return (30 mins)	< 0.023% / 0.017% FSO	Excitation Voltage (Maximum)	18V AC/DC
Zero Balance	< 1.000% Capacity	Storage Temperature Range	-60 ~ 185°F / -50 ~ 85°C
Temperature Effect on Span/10°C	< 0.010% FSO	Cable Type	4.5mm, Screened, PUR Sheath 4 Core x 0.24mm <sup>2</sup> (24 AWG)
Temperature Effect on Zero/10°C	< 0.015% Capacity	Cable Length	20 Feet / 6 Metres
Compensated Temperature Range	14 ~ 104°F / -10 ~ 40°C	Material	Alloy Tool Steel
Operating Temperature Range	0 ~ 150°F / -18 ~ 65°C	Finish	Electroless Nickel Plated
Service Load	100% of Rated Capacity		



Manufactured in New Zealand

PT Limited®  
<http://www.ptglobal.com>

## Ordering Information

MODEL	Part Number	MODEL	Part Number	MODEL	Part Number	CABLES PACKS	Part Number
PT4000-50lb	40P0050T000XXX	PT4000-1klb	40P1000T000XXX	PT4000-20kg	40M0020T000XXX	Junction box to indicator runs.	
PT4000-100lb	40P0100T000XXX	PT4000-1.5klb	40P1500T000XXX	PT4000-50kg	40M0050T000XXX	Available by the metre.	
PT4000-150lb	40P0150T000XXX	PT4000-2klb	40P2000T000XXX	PT4000-100kg	40M0100T000XXX	10 Metres	A-4C4.5-0010
PT4000-200lb	40P0200T000XXX	PT4000-2.5klb	40P2500T000XXX	PT4000-200kg	40M0200T000XXX	50 Metres	A-4C4.5-0050
PT4000-250lb	40P0250T000XXX	PT4000-3klb	40P3000T000XXX	PT4000-500kg	40M0500T000XXX	100 Metres	A-4C4.5-0100
PT4000-300lb	40P0300T000XXX	PT4000-5klb	40P5000T000XXX	PT4000-1t	40M1000T000XXX	Cable Joint Kit A-CAB-JOINTSTD	
PT4000-500lb	40P0500T000XXX	PT4000-10klb	40P10KBT000XXX	PT4000-2t	40M2000T000XXX		
PT4000-750lb	40P0750T000XXX	PT4000-20klb	40P20KBT000XXX	PT4000-3t	40M3000T000XXX		
		PT4000-45klb	40P45KBT000XXX	PT4000-5t	40M5000T000XXX		

### ACCESSORIES Part Number

	50lb ~ 300lb	500lb ~ 2.5klb	3klb	5klb	10klb	20klb
Load Button	A-LB0.250	A-LB0.500	A-LB0.500	A-LB0.750	A-LB0.750	A-LB1.250
Load Socket	A-LS20	A-LS20	A-LS20	A-LS30	A-LS30	A-LS75
Rod End	A-RE0.250N	A-RE0.500N	A-RE0.500-2N	A-RE0.750-2N	A-RE0.750-5N	A-RE1.250-10N
	20kg ~ 100kg	200kg ~ 1t	2t	3t ~ 5t		45klb
Load Button	A-LBM8	A-LBM12	A-LBM20	A-LBM24		A-LB1.250
Load Socket	A-LS20	A-LS20	A-LS30	A-LS30		A-LS75
Rod End	A-REM8N	A-REM12N	A-REM20N	A-REM24N		A-RE1.250-25N

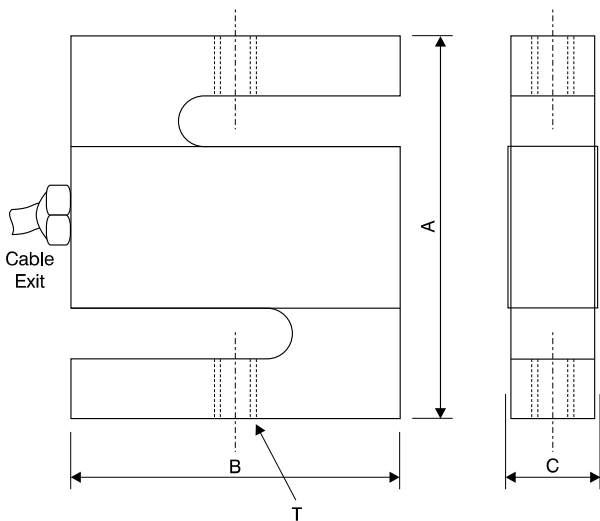

### Load Cell Dimensions

	A	B	C	T	Weight
50lb ~ 300lb	2.5	2	0.62	¼ UNF	0.90
500lb ~ 1.5klb	2.5	2	0.87	½ UNF	1.10
2klb ~ 2.5klb	2.5	2	1.1	½ UNF	1.40
3klb	3	2	1.1	½ UNF	1.60
5klb ~ 10klb	4	3	1.3	¾ UNF	3.30
20klb	5.9	4.5	2	1¼ UNF	5.75
45klb	6.3	6.2	2.8	1¼ UNF	9.7
<i>Dimensions in inches    Weight in lb</i>					
20kg ~ 100kg	63.5	51	16	M8 x 1.25P	0.41
200kg ~ 500kg	63.5	51	22	M12 x 1.75P	0.52
1t	63.5	51	28	M12 x 1.75P	0.64
2t	101.6	76	33	M20 x 1.5P	1.50
3t ~ 5t	101.6	76	33	M24 x 2P	1.50
<i>Dimensions in mm    Weight in kg</i>					

## Accessories

### PT Cable Colour Code

Excitation	+ve	<b>Red</b>
Sense	+ve	<b>Brown</b>
Excitation	-ve	<b>Black</b>
Sense	-ve	<b>Blue</b>
Signal	+ve	<b>Green</b>
Signal	-ve	<b>White</b>

